

Sales - House - Calahonda

465.000€

Calahonda

House

Community: 1,608 EUR / year

IBI: 1,032 EUR / year



4



2.5

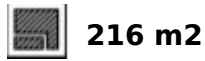

216 m2



56 m2

Set in the tranquil Pueblo La Paloma, Calahonda, this enchanting townhouse, constructed in 1998, seamlessly blends the timeless appeal of Spanish architectural elements with the comforts of modern living. This property stands out not only for its aesthetic allure but also for the thoughtful layout and features that cater to contemporary lifestyles. Spanning an impressive 216m², the house is meticulously designed to offer comfort. It accommodates four beautifully appointed bedrooms, each a tranquil retreat promising rest and relaxation. The natural light that floods through the windows illuminates each room, highlighting the tasteful details and creating a warm, welcoming atmosphere. The residence is served by 4 beds and 2.5 bathrooms, Each bathroom combines functionality with the unique charm of Spanish-inspired aesthetics, featuring vibrant tiles and quality fixtures. The kitchen stands as the heart of the home, blending rustic charm with modern functionality. It is equipped with contemporary appliances set against traditional décor, making it a delightful space for cooking and socializing. One of the crown jewels of this property is its roof terrace, offering breathtaking sea views that encapsulate the beauty of living in Pueblo La Paloma. This outdoor space is ideal for dining, sunbathing, or simply enjoying the. This Townhouse is a rare find in Calahonda, offering a perfect balance of traditional Spanish architecture, modern amenities, and stunning natural beauty. With its strategic location in Pueblo La Paloma, residents can enjoy the peace and serenity of the area while being close to all necessary conveniences and the vibrant life of the Costa del Sol.

Orientation

- ✓ South East
- ✓ South

Views

- ✓ Sea
- ✓ Pool

Garden

- ✓ Communal

Condition

- ✓ Good

Features

- ✓ Fitted Wardrobes
- ✓ Near Transport
- ✓ Private Terrace
- ✓ Utility Room
- ✓ Ensuite Bathroom

Parking

- ✓ Private

Pool

- ✓ Communal

Furniture

- ✓ Fully Furnished

Climate Control

- ✓ Fireplace

Kitchen

- ✓ Fully Fitted









































▼ 1st Floor

TOTAL AREA: 93.40 m² · LIVING AREA: 0.28 m² · ROOMS: 6

KAARSBERG

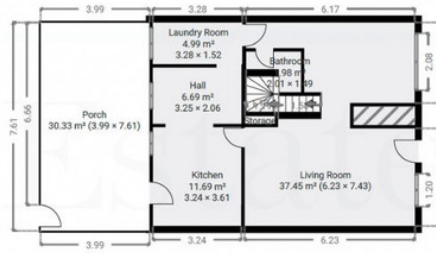

▼ 2nd Floor

TOTAL AREA: 68.76 m² · LIVING AREA: 2.32 m² · ROOMS: 8

KAARSBERG

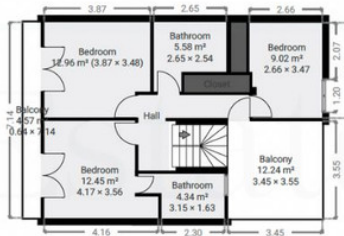

▼ 3rd Floor

TOTAL AREA: 41.18 m² · LIVING AREA: 0.00 m² · ROOMS: 2

