

Long Term Rental - Commercial - Puerto Banús

4.700€ / Month

Puerto Banús

Commercial



2



156 m2

Cristamar is a mall comprises by 114 local comercial in the heart of Puerto Banus, three levels with underground parking for your clients on the ground floor restaurants , shops, and services, pharmacy at the north corner a gym, and on the second floor offices

Setting

- ✓ Commercial Area
- ✓ Beachside
- ✓ Port
- ✓ Marina

Utilities

- ✓ Electricity
- ✓ Drinkable Water

Condition

- ✓ Good

Category

- ✓ Investment
- ✓ Resale

Climate Control

- ✓ Air Conditioning

Features

- ✓ Covered Terrace
- ✓ Lift







PLANTA ALTA

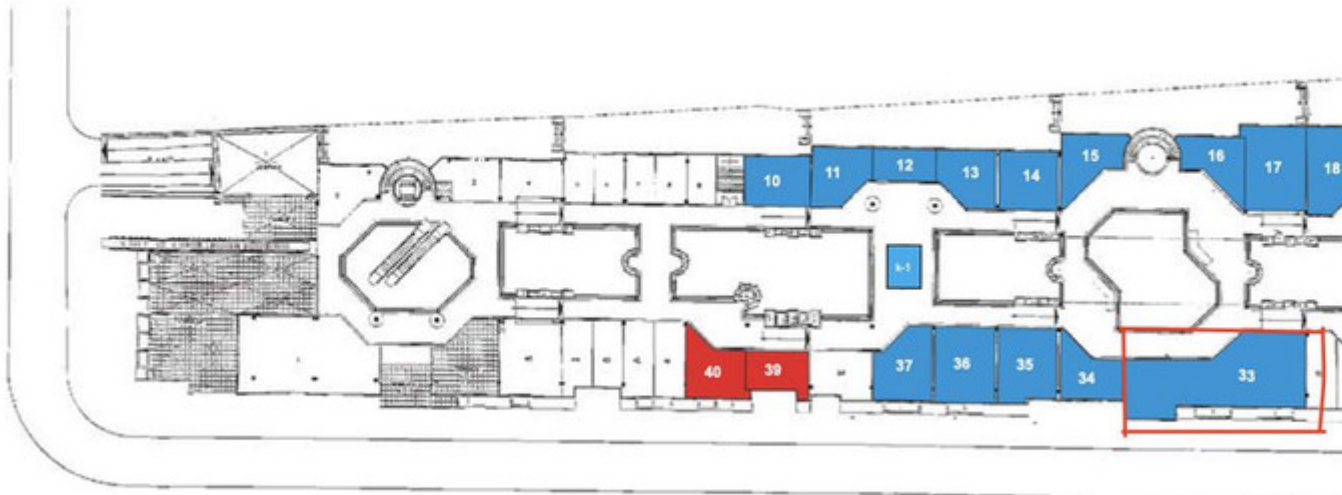

PLANTA RA.IA

PLANTA ALTA



PLANTA BAJA

