

Long Term Rental - Apartment - La Cala 2.500€ / Month

La Cala

Apartment

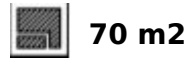

This 2-bedroom penthouse is located in the exclusive Cala Ipanema, in an unbeatable location. The area is known for its tranquility, surrounded by nature, with clear views of both the sea and the mountains, offering a perfect environment for those seeking relaxation and contact with nature. Penthouse Features: Bedrooms: 2 spacious and bright bedrooms. Condition: Unfurnished, offering the opportunity to personalize the space to your liking. Views: Stunning panoramic views of the sea and the mountains, providing a peaceful and serene environment. Rental Conditions: Duration: Available for long-term rental, ideal for those seeking an extended stay in a paradise-like setting. Optional: There is the possibility of furnishing it according to the tenant's needs, but in this case, the rental will be offered at a higher price. Unique Opportunity: Don't miss the opportunity to live in a penthouse in one of the most privileged areas, enjoying a natural environment and unparalleled views. Perfect for those seeking a quiet refuge away from the hustle and bustle of the city. For more information and visits, please do not hesitate to contact us.

























ipanelma

by Kivvies Homes

323A

BLOQUE 03

2 Dormitorio/s
2 Baño/s
2 Terraza/s

Superficie útil:
161,00m²

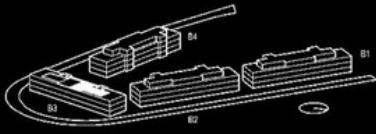

SUPERFICIES APROXIMADAS:

	SUP. DE PROYECTO	DECRETO 218/2005
Superficie útil interior	67,00m ²	
Superficie de terraza	94,00m ²	
Total superficie útil	161,00m ²	73,70m ²
<i>*Incluye útil interior y útil terrazas.</i>		
Total superficie construida	198,59m ²	90,86m ²
<i>*Incluye construida interior, de terraza y zona común proporcional.</i>		

