

Ref.-ID: MIBGR4208026

Elviria

Plot



1204 m2

GREAT INVESTMENT OPPORTUNITY IN ELVIRIA The plot is located on the first line of Santa Maria Golf and enjoys partial sea views. This project is only 1,7 km to the centre of Elvira and 2,4 km to the beach, where you will find all kinds of services, such as restaurants, supermarkets, banks, hotels, etc. Also, enjoy one of the beautiful sandy beaches with charming beach restaurants and the famous beach club Nikki Beach. Due to its positioning and the east facing, the spacious plot overlooks the beautiful Mediterranean and the Santa Maria Golf Course. The plot size is 1,204 sqm, and you can be built one villa. The urban regulations that apply to this plot are the following: EU-4 Buildability 0.20 m²/m²s Occupation 0.25% Maximum height 7.5 meters Elviria is a popular residential community located in the eastern part of Marbella, about 15 minutes drive to Marbella city centre and 25 minutes drive to the international airport of Malaga. Also, you will find nearby some of the best international schools, such as the English International College, the Deutsche Schule and Colegio Ecos.

Setting

- ✓ Frontline Golf
- ✓ Close To Golf
- ✓ Close To Shops
- ✓ Urbanisation

Category

- ✓ Investment

Orientation

- ✓ East
- ✓ South

Condition

- ✓ Good

Views

- ✓ Sea
- ✓ Mountain
- ✓ Golf





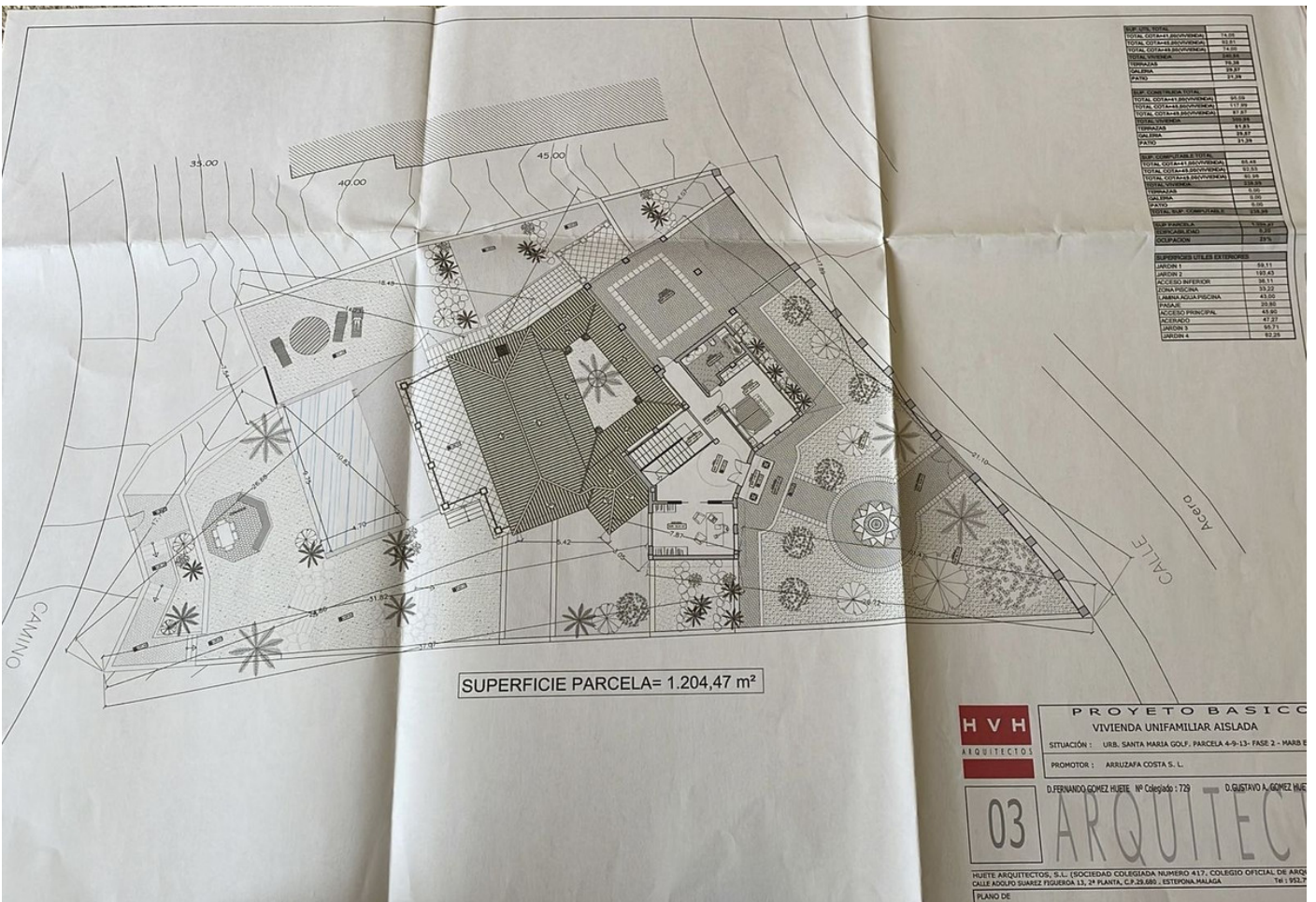

SUPERFICIE TOTAL	
TOTAL COCINA+BAÑO+DORMITORIO	11,35
TOTAL COCINA+BAÑO+DORMITORIO	11,35
TOTAL COCINA+BAÑO+DORMITORIO	14,30
TOTAL COCINA+BAÑO+DORMITORIO	14,30
TERRAZAS	1,20
PATIO	1,20
TOTAL	17,05

SUPERFICIE TOTAL	
TOTAL COCINA+BAÑO+DORMITORIO	11,35
TOTAL COCINA+BAÑO+DORMITORIO	11,35
TOTAL COCINA+BAÑO+DORMITORIO	11,35
TOTAL COCINA+BAÑO+DORMITORIO	11,35
TERRAZAS	1,20
PATIO	1,20
TOTAL	17,05

SUPERFICIE TOTAL	
TOTAL COCINA+BAÑO+DORMITORIO	11,35
TOTAL COCINA+BAÑO+DORMITORIO	11,35
TOTAL COCINA+BAÑO+DORMITORIO	11,35
TOTAL COCINA+BAÑO+DORMITORIO	11,35
TERRAZAS	1,20
PATIO	1,20
TOTAL	17,05

SUPERFICIE TOTAL	
TOTAL COCINA+BAÑO+DORMITORIO	11,35
TOTAL COCINA+BAÑO+DORMITORIO	11,35
TOTAL COCINA+BAÑO+DORMITORIO	11,35
TOTAL COCINA+BAÑO+DORMITORIO	11,35
TERRAZAS	1,20
PATIO	1,20
TOTAL	17,05

HVH
ARQUITECTOS

PROYECTO BASICO
VIVIENDA UNIFAMILIAR AISLADA

SITUACIÓN : URB. SANTA MARIA GOLF, PARCELA 4-9-13- FASE 2 - MARB E

PROMOTOR : ARRUIFAZA COSTA S. L.

D.FERNANDO GOMEZ HUETE Nº Colegiado : 1.729 D.GUSTAVO A. GOMEZ HUETE

03

ARQUITECTOS

HUETE ARQUITECTOS, S.L. (SOCIEDAD COLIGADA NUMERO 417, COLEGIO OFICIAL DE ARQ. CALLE KOLEJO SUAREZ FIGUEROA 13, 2º PLANTA, CP 28.080, ESTREPOSA-MÁLAGA Tlf : 952.7

PLANO DE

