

Ref.-ID: MIBGR4662202

Calahonda

Apartment

Community: 864 EUR / year

IBI: 450 EUR / year



2



1



70 m2

This fantastic penthouse has been completely renovated, creating a dream home with sea views in an idyllic location on the Costa del Sol. The property is delivered with brand new furniture and it has a Tourist License. 70m² built area distributed in an entrance hall, bathroom with shower, two bedrooms, a spacious living room with direct access to a private terrace of 22m² with lots of light thanks to its south orientation. From this terrace, you can enjoy stunning sea views. The modern designer kitchen blends perfectly into the living room creating a stylish and functional open-concept space. A highlight of this home is the large solarium with 52m² of private access that provides an exceptional place ideal for enjoying meetings with friends and family. The community has well-kept gardens, a swimming pool and communal parking. Located just a few minutes from the picturesque town of La Cala de Mijas and its golden sandy beaches, close to golf courses, shops, services and restaurants. It also has easy access to the motorway that connects the city of Malaga with all the towns on the Costa del Sol. Whether you are looking for a charming holiday home, a smart investment or your permanent residence, this penthouse meets all the requirements. Book an appointment and we will show you this great OPPORTUNITY!

Setting

- ✓ Beachside
- ✓ Close To Golf
- ✓ Close To Shops
- ✓ Close To Sea
- ✓ Urbanisation

Climate Control

- ✓ Air Conditioning
- ✓ Hot A/C
- ✓ Cold A/C

Kitchen

- ✓ Fully Fitted
- ✓ Kitchen-Lounge

Utilities

- ✓ Electricity
- ✓ Drinkable Water
- ✓ Telephone

Orientation

- ✓ South

Views

- ✓ Sea
- ✓ Mountain
- ✓ Beach
- ✓ Panoramic

Garden

- ✓ Communal

Category

- ✓ Holiday Homes
- ✓ Investment

Condition

- ✓ Excellent
- ✓ Recently Refurbished

Features

- ✓ Covered Terrace
- ✓ Lift
- ✓ Fitted Wardrobes
- ✓ Near Transport
- ✓ Private Terrace
- ✓ Solarium
- ✓ Wood Flooring
- ✓ Marble Flooring
- ✓ Double Glazing
- ✓ Courtesy Bus

Security

- ✓ Gated Complex
- ✓ Entry Phone

Pool

- ✓ Communal

Furniture

- ✓ Fully Furnished

Parking

- ✓ Communal



















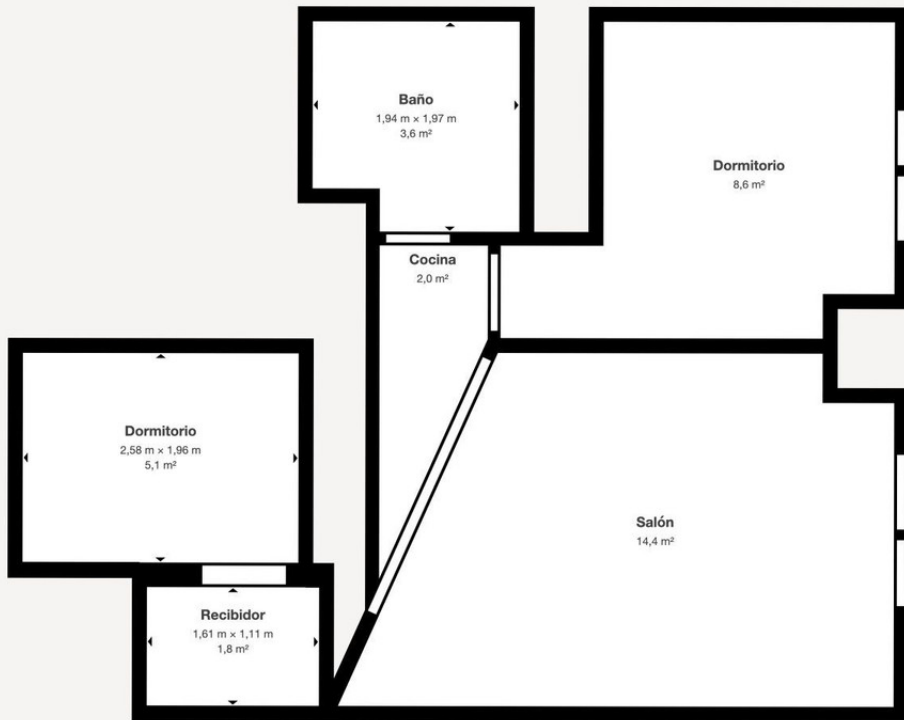

Don Piso Lince

Indoor Scanned Area - Full Property 35,5 m² | Floor 1 35,5 m²

Sizes and dimensions are approximate, actual may vary













