

**Ref.-ID: MIBGR4733761**

**Benalmadena Costa**

**Apartment**

**Community: 1,200 EUR / year**

**IBI: 657 EUR / year**



**2**



**1**



**134 m2**

This first line penthouse is located in the beautiful area of Benalmadena Costa. Just on the boarder of Fuengirola. It has been carefully renovated in an open, bright Scandinavian style. In addition, it features a huge terrace where you can enjoy breath-taking views of the sea, the coastline of Fuengirola. You got sun all day, from early morning until it sets behind the mountains. As you enter the penthouse, you will be greeted by a bright and airy living area. The fully fitted kitchen is equipped with modern appliances, making it a perfect space for culinary enthusiasts. The property also boasts amenities such as air conditioning and double glazing, ensuring a comfortable and energy-efficient living environment. The private terrace is unique in every aspect, an ideal spot for outdoor entertaining or simply relaxing and taking in the stunning surroundings. The terrace features a barbeque, dining area, allowing you to enjoy al fresco dining while enjoying the panoramic views. Something that is very convenient in Spain, when you live most of you day and evenings outdoors. Other notable features of this penthouse include parquet floors, fitted wardrobes, and an armoured door for added security. The property is part of a gated community with a communal pool and garden, providing residents with a tranquil and exclusive living experience. Additionally, the penthouse comes with a private garage, ensuring convenient parking. This luxury penthouse is conveniently located close to various amenities, including shops, restaurants, and schools. It is also within walking distance to the beach, making it perfect for those who enjoy a coastal lifestyle. Furthermore, the property offers easy access to transport links, allowing for convenient travel to other parts of the city. In summary, this luxury penthouse in Benalmadena Costa offers a unique opportunity to live in a stunning property with breath taking sea and mountain views. With its modern features, spacious terrace, and convenient location, this property is an excellent choice for those seeking a luxurious and comfortable lifestyle.

**Setting**

- ✓ Close To Golf
- ✓ Close To Port
- ✓ Close To Shops
- ✓ Close To Sea
- ✓ Close To Town
- ✓ Close To Schools

**Climate Control**

- ✓ Air Conditioning

**Kitchen**

- ✓ Fully Fitted

**Orientation**

- ✓ South West

**Views**

- ✓ Sea
- ✓ Mountain
- ✓ Port
- ✓ Panoramic
- ✓ Pool

**Garden**

- ✓ Communal

**Condition**

- ✓ Excellent

**Features**

- ✓ Lift
- ✓ Fitted Wardrobes
- ✓ Near Transport
- ✓ Private Terrace
- ✓ Wood Flooring
- ✓ Barbeque
- ✓ Double Glazing

**Parking**

- ✓ Private

**Pool**

- ✓ Communal

**Furniture**

- ✓ Optional

**Category**

- ✓ Luxury







































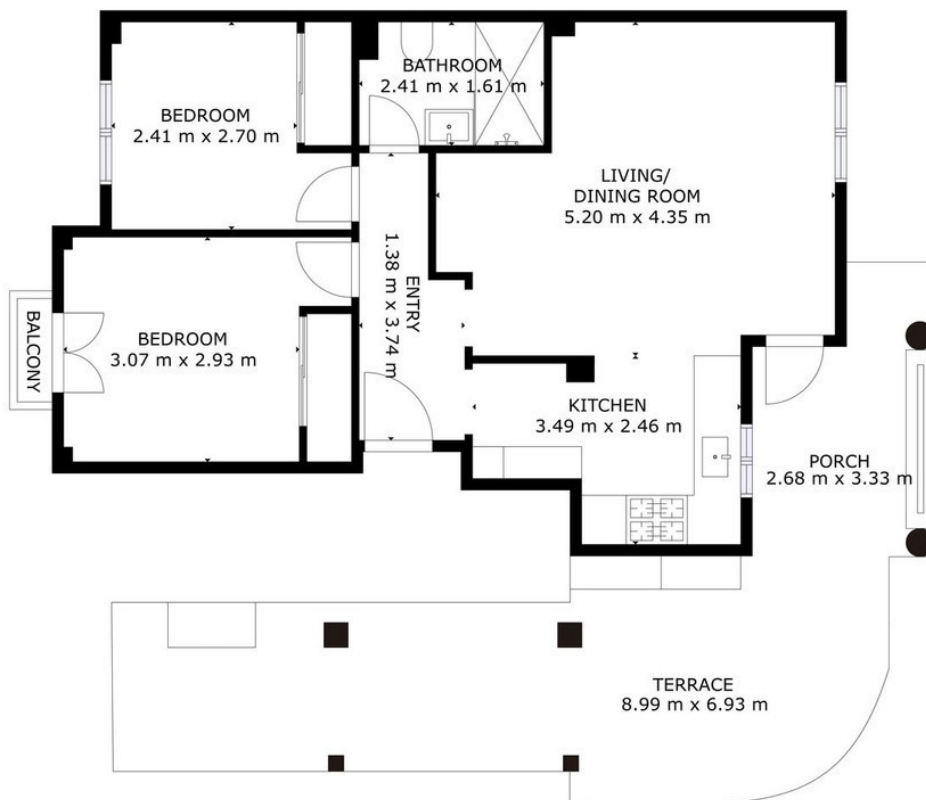

FLOOR 1

GROSS INTERNAL AREA  
TOTAL: 56 m<sup>2</sup>  
SIZE AND DIMENSIONS ARE APPROXIMATE, ACTUAL MAY VARY