

Ref.-ID: MIBGR3806164

La Cala

Участок



40000 m2

Excellent opportunity to invest and acquire this land with cadastral reference 29070A024000250000A. Very good views and good access with tarmac road. It is situated to the south of the motorway and half of the land is planted with more than 150 olive trees. It has its own well, but at the moment it is not working. The electricity connection is at the entrance of the property. House in ruins of 140 m2. According to the new Law of Impulse for the Sustainability of the Territory of Andalusia (LISTA) it is allowed to build a house of 300 m2. The finca is only 5 minutes drive from La Cala de Mijas. Located in the Lagar Martell sector in the town of Mijas, province of Malaga. The geographical situation of this locality allows this sector to be privileged as it is only 10 minutes by car from La Cala Beach, Butibamba Beach, Chaparral Beach and Samuel Oliva Equestrian Club. It corresponds to a sector in tourist development in the vicinity of several golf courses such as Santana Golf Club, Cerrado del Aguila Golf and Resort and La Cala Golf Club.

Расположение

- ✓ Рядом с гольф-полем
- ✓ Рядом с морем
- ✓ Близко к школам

Особенности

- ✓ Возле церкви

ОРИЕНТАЦИЯ

- ✓ Юг

Сад

- ✓ Приватный

Состояние

- ✓ Хорошее

Категория

- ✓ Выгодное предложение

ВИД

- ✓ Море
- ✓ Панорамный











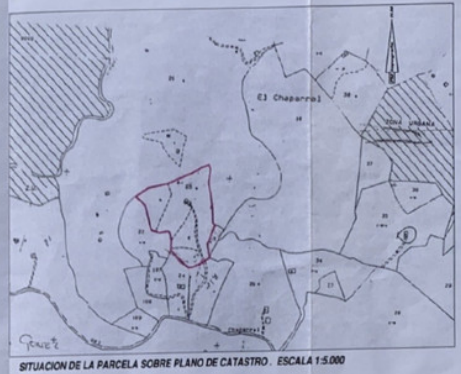
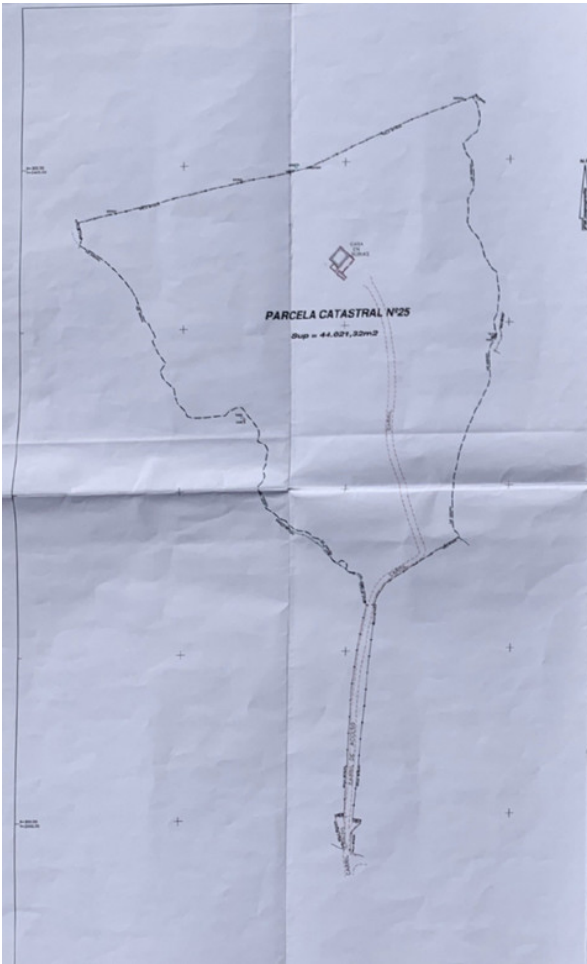

OFICINA DE OBRAS PUBLICAS DEL MUNICIPIO DE LA PAZ
DIRECCION DE INGENIERIA Y ARQUITECTURA

FM topografía

LOCALIDAD: TERNI MUNICIPIO DE MURAHUALLA
SITUACION: EL CHAÑARAL - FINCA LA CALA - PARCELA DE
PLANO: PARCELA CATASTRAL N°25
PROPIETARIO: GEMARCA S.A.
ESCALA: 1:10.000 | QUANTIFICACION: 10000 | FECHA: MARZO 2008
EL DISEÑO SE HIZO EN TERNI

INSTRUMENTOS: NIVELACION
EQUIPAMIENTO: ESTACION TOTAL
PROYECTO: 100.000
DISEÑO: 100.000
COTEA: 100.000
EL DISEÑO SE HIZO EN TERNI

